



WRR HM LED
IP40

LED INDOOR



HIGH CRI >80
Technology SMD

DESCRIPTIONS

WRR HF LED IP40 is a decorative surface mounted wrap around LED luminaire coming with high efficient electronic driver as per Saudi and international standards. The housing is made of steel housing finished with 3-stages pretreatment electrostatic powder coating. The luminaire has polycarbonate covers (prismatic) which gives more light uniformity.

APPLICATIONS

Schools, hospitals, and all other similar applications.

DIMENSIONS

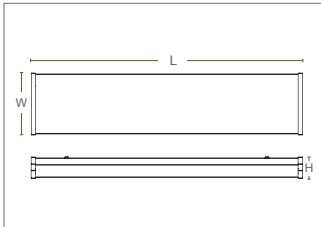

SPECIFICATIONS

Mounting	Surface & Wall mounted
LED module type	SMD LED chips
Voltage rating/ freq.	220-240V / 50-60 Hz
Driver	Integrated Electronic LED driver
Power factor	>0.95
Degree of protection	IP 40
Light controller	Prismatic cover
Standard color temp.	3000K/4000K/6500K
Operating temperature	-10 : 40°C
Rated lifetime (L70)	50,000 Hrs (@25C°)

CODE	Wattage	Lumin	IP Rate	L	W	H
WRR-HM-25W	25W	2500LM	IP40	645	208	70
WRR-HM-36W	36W	3600LM	IP40	1255	208	70
WRR-HM-50W	50W	5000LM	IP40	1255	208	70

MOUNTING SYSTEM

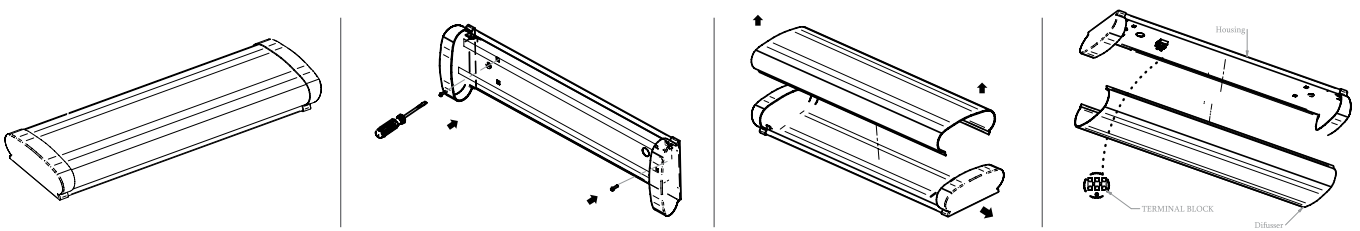

Head office

Malaz - Salahidin Road
P.O Box 1246 Riyadh 11431

Tel : +966 11 4777 700
Fax: +966 11 4789 469

Western Region Office

Tahliya Street
P.O Box 20798 Jeddah 21465

Tel : +966 12 6650888
Fax: +966 12 6633413

Eastern Region Office

King Abdulaziz Street
P.O Box 8492 Dammam 31482

Tel : +966 13 8336509
Fax: +966 13 8329065

ContactUs@noortek.com



www.noortek.com