



BATTENS

LINALUX T8



SPECIFICATIONS :

Mounting	: Surface mounted (Ceiling / Wall)
Lamp type	: T8
Lamp holder	: G13
Control gear type	: Electronic
Voltage Rating/ Freq.	: 220-240V / 50-60 Hz
Power factor	: >0.95
Degree of protection	: IP 20
Internal Wiring	: 0.5 mm sq. solid copper wire, PVC 105 deg C .
Cable entry	: 16mm diam hole at the end/bottom of the housing
Cable connection	: Terminal block, 3-pole, screw type with grounding
Conformity	: IEC 60598 / SASO 1318
Optical system	: BL /WR

DESCRIPTIONS : LINALUX T8 is a surface mounted luminaire of 0.6 mm steel housing finished with 3-stages pretreatment electrostatic powder coating. It is available in two versions; as a bare lamp or with a white powder coated reflector. LOR reaches up to 91%. DIAL certified photometry. Energy efficiency is obtained using an electronic ballast with PF higher than 0.95.

APPLICATIONS : Cove lighting, supermarkets, labs and workshops.



Glare Evaluation According to UGR

ρ Ceiling	70	70	50	50	30	70	70	50	50	30	
ρ Walls	50	30	50	30	30	50	30	50	30	30	
ρ Floor	20	20	20	20	20	20	20	20	20	20	
Room Size X Y	Viewing direction at right angles to lamp axis					Viewing direction parallel to lamp axis					
2H	2H	19.4	20.5	20.0	21.2	22.0	16.7	17.9	17.4	18.5	19.3
	3H	22.0	23.1	22.7	23.8	24.6	18.4	19.4	19.0	20.1	20.9
	4H	23.2	24.2	24.0	25.0	25.8	18.9	19.9	19.6	20.6	21.5
	6H	24.4	25.3	25.1	26.1	27.0	19.3	20.2	20.0	21.0	21.8
	8H	25.0	25.9	25.7	26.6	27.5	19.4	20.3	20.1	21.0	21.9
	12H	25.5	26.4	26.3	27.1	28.0	19.4	20.2	20.1	21.0	21.9
4H	2H	19.8	20.8	20.5	21.5	22.4	17.9	18.9	18.6	19.6	20.5
	3H	22.7	23.6	23.5	24.3	25.2	19.9	20.8	20.7	21.5	22.4
	4H	24.2	24.9	24.9	25.7	26.6	20.7	21.5	21.5	22.3	23.2
	6H	25.5	26.2	26.3	27.0	28.0	21.3	22.0	22.1	22.8	23.7
	8H	26.2	26.8	27.0	27.6	28.6	21.5	22.1	22.3	22.9	23.9
	12H	26.9	27.4	27.7	28.3	29.2	21.5	22.1	22.3	22.9	23.9
8H	4H	24.4	25.1	25.2	25.9	26.9	21.7	22.3	22.5	23.1	24.1
	6H	26.1	26.6	26.9	27.4	28.4	22.6	23.1	23.4	24.0	25.0
	8H	26.9	27.4	27.7	28.2	29.2	22.9	23.4	23.8	24.3	25.3
	12H	27.8	28.2	28.6	29.0	30.1	23.2	23.6	24.0	24.4	25.5
12H	4H	24.4	25.0	25.3	25.8	26.8	21.9	22.5	22.7	23.3	24.3
	6H	26.1	26.6	27.0	27.5	28.5	23.0	23.5	23.8	24.3	25.4
	8H	27.1	27.5	27.9	28.3	29.4	23.5	23.9	24.3	24.8	25.8
Variation of the observer position for the luminaire distances S											
S = 1.0H						+0.1 / -0.1					
S = 1.5H						+0.2 / -0.2					
S = 2.0H						+0.3 / -0.4					
Standard table	BK 11					BK 13					
Correction Summand	10.7					6.1					

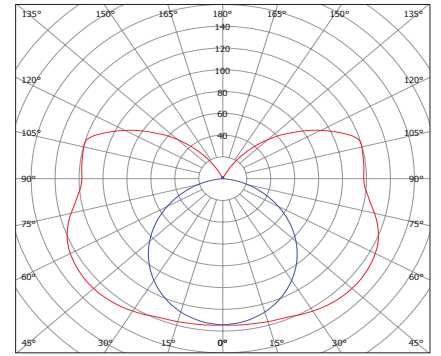

BAT-T8-1X18WE/BL
For the rest refer to page - 436

LOR-91%

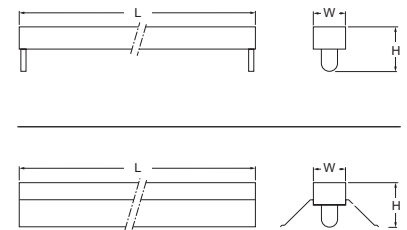

Corrected Glare Indices referring to 1350lm Total Luminous Flux

The UGR values have been calculated according to CIE Publ. 117 Spacing-to-Height-Ratio = 1.00.

CODE	L	W	H	CODE	L	W	H
BAT-T8-1X18WE/BL	619	50	70	BAT-T8-1X36WE/BL	1228	50	70
BAT-T8-1X18WE/WR	619	135	73	BAT-T8-1X36WE/WR	1228	140	78
BAT-T8-1X58WE/BL	1528	50	70				
BAT-T8-1X58WE/WR	1528	140	78				



OPTIONS:

- Gear (DIM) [DALI]
- Emergency Kit (EM1.5) [EM3]
- Aluminium [ALU]

Ordering Example



Mounting System

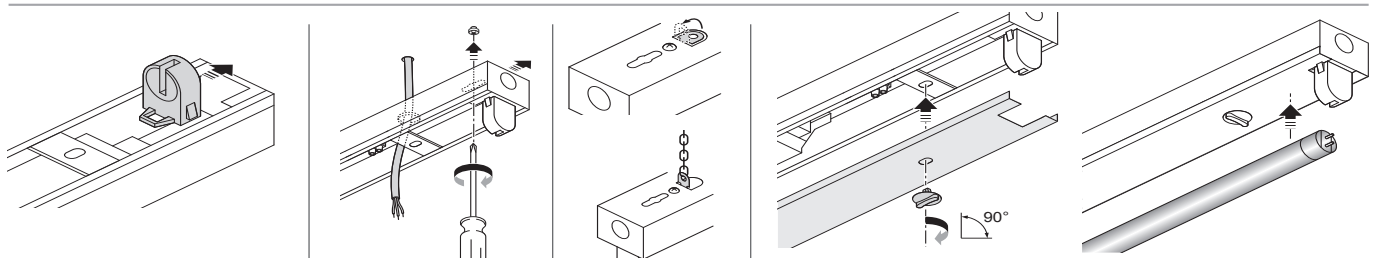



SPECIFICATIONS :

Mounting	: Surface Mounted (Ceiling / Wall)
Lamp type	: T8
Lamp holder	: G13
Control gear type	: Electronic
Voltage Rating/ Freq.	: 220-240V / 50-60 Hz
Power factor	: >0.95
Degree of protection	: IP 20
Internal Wiring	: 0.5 mm sq. solid copper wire, PVC 105 deg C .
Cable entry	: 16mm diam hole at the end/bottom of the housing
Cable connection	: Terminal block, 3-pole, screw type with grounding
Conformity	: IEC 60598 / SASO 1318
Optical system	: BL /WR

DESCRIPTIONS : LINALUX T8 is a surface mounted luminaire of 0.6 mm steel housing finished with 3-stages pretreatment electrostatic powder coating. It is available in two versions; as a bare lamp or with a white powder coated reflector. LOR reaches up to 92%. DIAL certified photometry. Energy efficiency is obtained using an electronic ballast with PF higher than 0.95.

APPLICATIONS : Cove lighting, supermarkets, labs and workshops.



Glare Evaluation According to UGR

Room Size X		Viewing direction at right angles to lamp axis					Viewing direction parallel to lamp axis				
ρ Ceiling		70	70	50	50	30	70	70	50	50	30
ρ Walls		50	30	50	30	30	50	30	50	30	30
ρ Floor		20	20	20	20	20	20	20	20	20	20
Room Size Y											
2H	2H	20.3	21.3	21.0	22.1	23.0	18.4	19.5	19.2	20.2	21.2
	3H	23.2	24.1	24.0	24.9	25.9	20.0	20.9	20.8	21.7	22.7
	4H	24.4	25.3	25.2	26.1	27.1	20.5	21.4	21.3	22.2	23.2
	6H	25.4	26.2	26.2	27.0	28.1	20.8	21.6	21.6	22.4	23.4
	8H	25.8	26.6	26.6	27.4	28.4	20.8	21.6	21.6	22.4	23.5
	12H	26.1	26.9	26.9	27.7	28.7	20.8	21.5	21.6	22.4	23.4
4H	2H	20.7	21.5	21.5	22.3	23.3	19.3	20.2	20.1	21.0	22.0
	3H	23.9	24.7	24.8	25.5	26.5	21.2	21.9	22.0	22.8	23.8
	4H	25.3	26.0	26.2	26.9	27.9	21.9	22.6	22.8	23.4	24.5
	6H	26.5	27.1	27.4	27.9	29.0	22.4	22.9	23.2	23.8	24.9
	8H	26.9	27.5	27.8	28.4	29.5	22.5	23.0	23.4	23.9	25.0
	12H	27.4	27.8	28.2	28.7	29.9	22.5	23.0	23.4	23.9	25.0
8H	4H	25.6	26.1	26.5	27.0	28.1	23.1	23.6	24.0	24.5	25.6
	6H	27.0	27.4	28.0	28.4	29.5	24.1	24.5	25.0	25.4	26.6
	8H	27.6	28.0	28.5	28.9	30.0	24.1	24.5	25.0	25.4	26.5
	12H	28.1	28.5	29.1	29.4	30.6	24.3	24.6	25.2	25.5	26.7
12H	4H	25.6	26.1	26.5	27.0	28.1	23.1	23.6	24.0	24.5	25.6
	6H	27.0	27.4	28.0	28.4	29.5	24.1	24.5	25.0	25.4	26.6
	8H	27.7	28.0	28.6	29.0	30.2	24.5	24.9	25.4	25.8	27.0
Variation of the observer position for the luminaire distances S											
S = 1.0H											+0.0 / -0.1
S = 1.5H											+0.2 / -0.2
S = 2.0H											+0.2 / -0.3
Standard table											BK 10
Correction Summand											8.9
											BK 14
											4.7

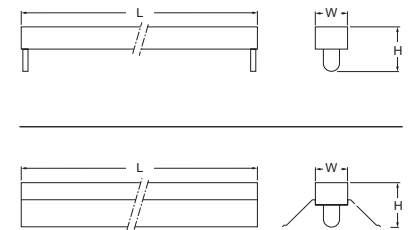
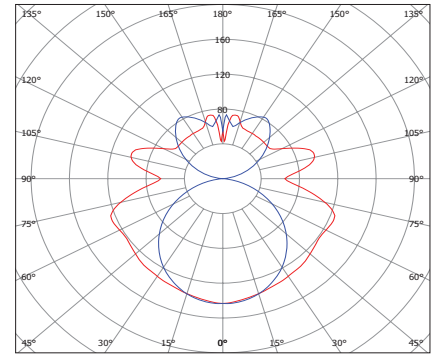

Corrected Glare Indices referring to 2700lm Total Luminous Flux
The UGR values have been calculated according to CIE Publ. 117 Spacing-to-Height-Ratio = 1.00.

CODE	L	W	H
BAT-T8-2X18WE/BL	619	50	75
BAT-T8-2X18WE/WR	619	165	78
BAT-T8-2X58WE/BL	1528	50	75
BAT-T8-2X58WE/WR	1528	165	78

CODE	L	W	H
BAT-T8-2X36WE/BL	1228	50	75
BAT-T8-2X36WE/WR	1228	165	78



OPTIONS:

- Gear (DIM) [DALI]
- Emergency Kit (EM1.5) [EM3]
- Aluminium [ALU]

Ordering Example



Mounting System

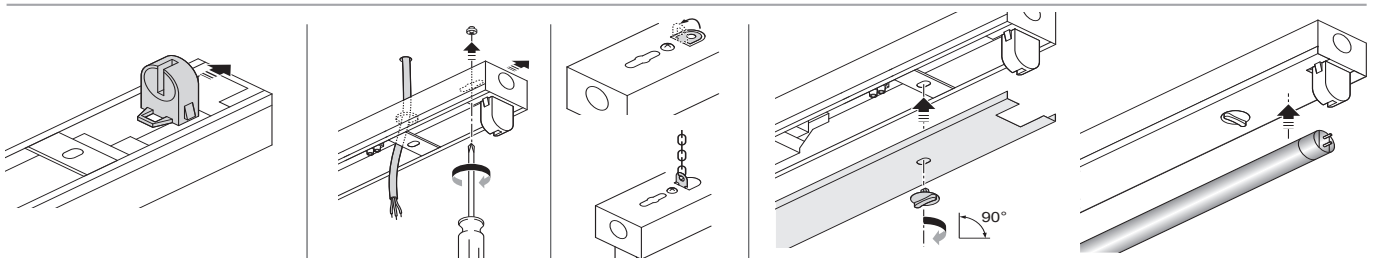

Head office

Malaz - Salahidin Road
P.O Box 1246 Riyadh 11431

Tel : +966 11 477 77 00
Fax: +966 11 478 94 69

Western Region Office

Tahliya Street
P.O Box 20798 Jeddah 21465

Tel : +966 12 6650888
Fax: +966 12 6633413

Eastern Region Office

King Abdulaziz Street
P.O Box 8492 Dammam 31482

Tel : +966 13 8336509
Fax: +966 13 8329065

ContactUs@noortek.com



www.noortek.com