



UPLUX
UL02X SERIES



GENERAL SPECIFICATIONS :

Head Material	: Die-cast aluminium
Cover ring	: Die-cast aluminium round
Lamp Type	: Halogen/MH
Lamp holder	: G12
Voltage rating/ freq.	: 220-240V / 50-60 Hz
Control gear type	: HPF conventional control gear (MH)
Power factor	: >0.9
Degree of protection	: IP 67
Optical configuration	: Pure anodized aluminium louver
Finishing	: Durable enamel finish
Glass	: 6mm Tempered safety glass
Static pressure	: 2800 Kg

DESCRIPTIONS : UPLUX UL02X series is drive over guide light that provides a professional lighting solution for landscape and path ways. Using die casted aluminium housing and 6mm tempered safety glass can be used in all environments. It is also suitable for static pressure upto 2800kg.

APPLICATIONS : Landscape , path ways and othe similar applications.



OUTDOOR

UPLUX

UL02X SERIES

SPECIFICATIONS :

Lamp type	: 12V Halogen	Metal Halide
Lamp wattage	: 50W/100W	20W MH
Beam angle	: 4°/8°/24°/45°	6°
Control gear	: HF electronic transformer	Electronic ballast

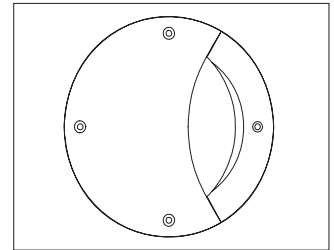
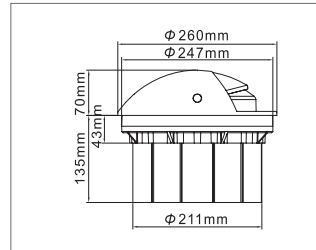

CODE	D	H
UPLUX (UL021)-35W MH	260	205

SPECIFICATIONS :

Lamp type	: Metal Halide
Lamp wattage	: 35W/70W
Beam angle	: 6°/12°/24°/32°
Control gear	: HPF conventional control gear

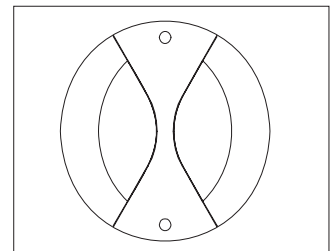
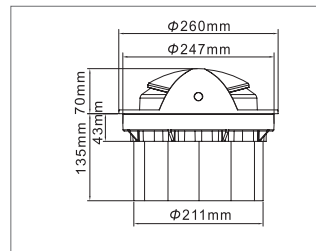

CODE	D	H
UPLUX (UL022)-35W MH	260	205

SPECIFICATIONS :

Lamp type	: Metal Halide
Lamp wattage	: 150W
Beam angle	: 6°/12°/24°/32°
Control gear	: HPF conventional control gear

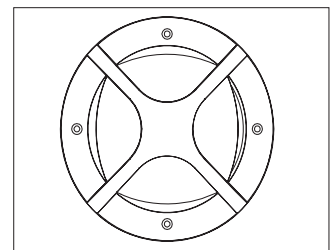
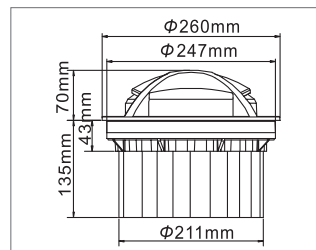

CODE	D	H
UPLUX (UL023)-35W MH	260	205

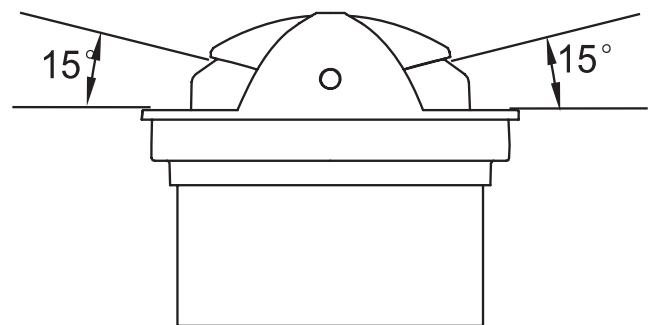
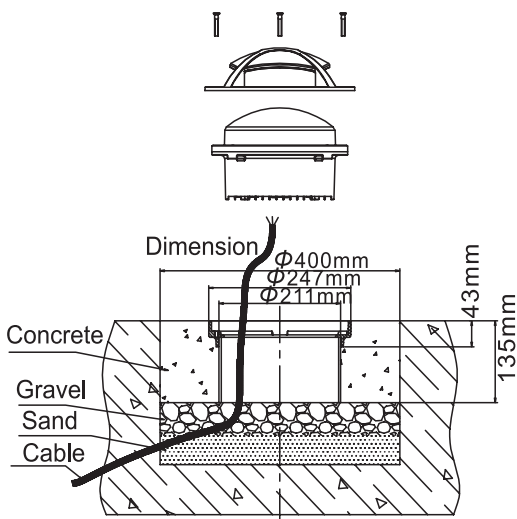

Head office

Malaz - Salahidin Road
P.O Box 1246 Riyadh 11431

Tel : +966 11 477 77 00
Fax: +966 11 478 94 69

Western Region Office

Tahliya Street
P.O Box 20798 Jeddah 21465

Tel : +966 12 6650888
Fax: +966 12 6633413

Eastern Region Office

King Abdulaziz Street
P.O Box 8492 Dammam 31482

Tel : +966 13 8336509
Fax: +966 13 8329065

ContactUs@noortek.com



www.noortek.com