



LED - D20A
ADJUSTABLE

LED DOWNLIGHT



DESCRIPTIONS

The D20A is a recessed adjustable LED downlight series with high quality die-cast aluminum body in powder-coated, Equipped with good quality aluminum reflector with 15D or 24D or 38D beam angles, available in different trims and reflectors option. Excellent heat sink capability to minimize the luminous degradation, remote LED driver.

APPLICATIONS

General lighting, residential etc.

PHOTOMETRIC DATA

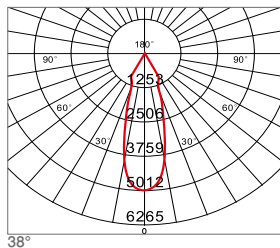

DIMENSIONS

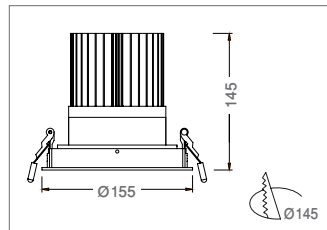

SPECIFICATIONS

Housing	Die casted aluminum
LED module type	COB LED chips
Voltage rating/ freq.	220-240V / 50-60 Hz
Driver	Constant current LED driver
Beam Angle	15°/24°/38°
Light output	90Lm/W
Degree of protection	IP40
Color temp.	3000K/4000K/6500K
Rated lifetime (L70)	50,000 Hrs (@25C°)

CODE	Wattage	Lumin	IP Rate	Color Temp.		Ø	H
D201A-30W	30W	2700LM	IP40	3K/4K/6.5K	145	155	145
D202A-35W	35W	3150LM	IP40	3K/4K/6.5K	145	155	145
D203A-40W	40W	3600LM	IP40	3K/4K/6.5K	145	155	145

MOUNTING SYSTEM

OPTIONS:

- Dimmable Driver 1 - 10 / DALI
- Backup Emergency Kit 3H
- Frosted / Semi frosted glass diffuser

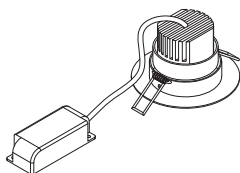

Product Overview

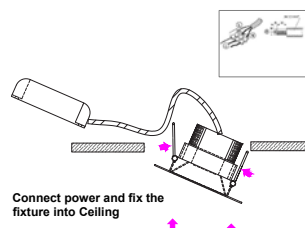
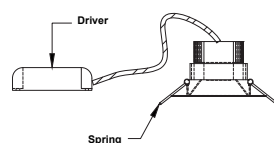

Connect power and fix the fixture into Ceiling



Head office

Malaz - Salahidin Road
P.O Box 1246 Riyadh 11431

Tel : +966 11 4777 700
Fax: +966 11 4789 469

Western Region Office

Tahliya Street
P.O Box 20798 Jeddah 21465

Tel : +966 12 6650888
Fax: +966 12 6633413

Eastern Region Office

King Abdulaziz Street
P.O Box 8492 Dammam 31482

Tel : +966 13 8336509
Fax: +966 13 8329065

ContactUs@noortek.com



www.noortek.com