



RECESSED

OFFILUX T5 IP 65

RECESSED

OFFILUX T5 IP 65



SPECIFICATIONS :

Mounting	: Ceiling recessed
Lamp type	: T5
Lamp holder	: G5
Control gear type	: Electronic
Voltage rating/ freq.	: 220-240V / 50-60 Hz
Power factor	: >0.95
Degree of protection	: IP 65
Internal wiring	: 0.5 mm sq. solid copper wire, PVC 105 deg C
Cable entry	: 16mm dia. hole on bottom of the housing
Cable connection	: Terminal block, 3-pole, screw type with grounding
Conformity	: IEC 60598 / SASO 1318
Light Controller	: SP-S/DP-S/SP-M/DP-M Clear tempered glass

DESCRIPTIONS : OFFILUX T5 IP65 is a recessed luminaire of 0.6 mm steel housing finished with 3-stages pretreatment electrostatic powder coating. The aluminum optic is used with purity higher than 99% and reflectance higher than 80% and is covered with clear tempered glass. High ingress protection (IP 65) offers total protection against dust and jetting water. Energy efficiency is obtained using electronic ballast with PF higher than 0.95.

APPLICATIONS : Hospitals, laboratories and industrial applications.

CODE	L	W	H
REC-T5-3/4X14WE/SP-S [IP 65]	597	597	54
REC-T5-3/4X14WE/DP-S [IP 65]	597	597	54
REC-T5-3/4X14WE/SP-M [IP 65]	597	597	54
REC-T5-3/4X14WE/DP-M [IP 65]	597	597	54

OPTIONS:

- Gear (DIM) [DALI] [2xEB]
- Emergency Kit (EM1.5) [EM3] [2xEM3] [DALI-EM3]



Ordering Example

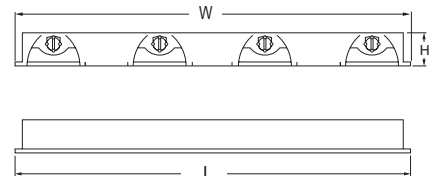

Mounting System

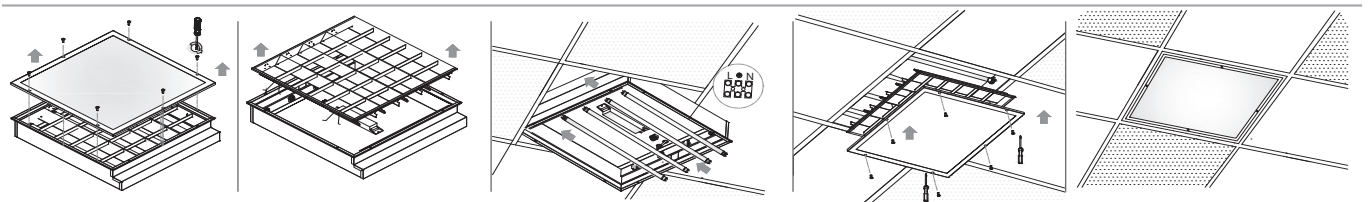

RECESSED

OFFILUX T5 IP 65



SPECIFICATIONS :

Mounting	: Ceiling recessed
Lamp type	: T5
Lamp holder	: G5
Control gear type	: Electronic
Voltage rating/ freq.	: 220-240V / 50-60 Hz
Power factor	: >0.95
Degree of protection	: IP 65
Internal wiring	: 0.5 mm sq. solid copper wire, PVC 105 deg C
Cable entry	: 16mm dia. hole on bottom of the housing
Cable connection	: Terminal block, 3-pole, screw type with grounding
Conformity	: IEC 60598 / SASO 1318
Light Controller	: SP-S/DP-S/SP-M/DP-M Clear tempered glass

DESCRIPTIONS : OFFILUX T5 IP65 is a recessed luminaire of 0.6 mm steel housing finished with 3-stages pretreatment electrostatic powder coating. The aluminum optic is used with purity higher than 99% and reflectance higher than 80% and is covered with clear tempered glass. High ingress protection (IP 65) offers total protection against dust and jetting water. Energy efficiency is obtained using electronic ballast with PF higher than 0.95.

APPLICATIONS : Hospitals, laboratories and industrial applications.

CODE	L	W	H
REC-T5-3X28WE/SP-S (IP 65)	1197	597	54
REC-T5-3X28WE/DP-S (IP 65)	1197	597	54
REC-T5-3X28WE/SP-M (IP 65)	1197	597	54
REC-T5-3X28WE/DP-M (IP 65)	1197	597	54

CODE	L	W	H
REC-T5-2X28WE/SP-S (IP 65)	1197	297	54
REC-T5-2X28WE/DP-S (IP 65)	1197	297	54
REC-T5-2X28WE/SP-M (IP 65)	1197	297	54
REC-T5-2X28WE/DP-M (IP 65)	1197	297	54

OPTIONS:

- Gear (DIM) (DALI)
- Emergency Kit (EM1.5) (EM3)



Ordering Example

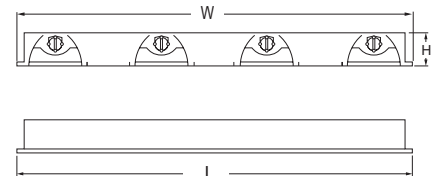
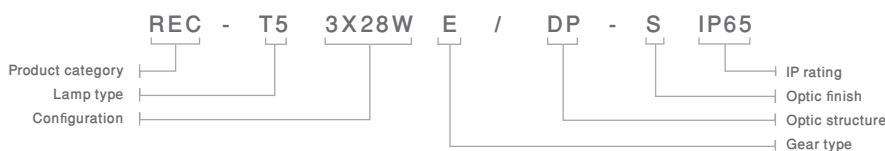

Mounting System

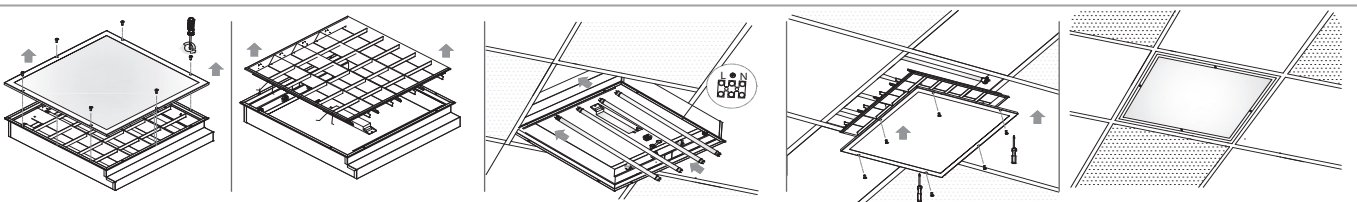

Head office

Malaz - Salahidin Road
P.O Box 1246 Riyadh 11431

Tel : +966 11 477 77 00
Fax: +966 11 478 94 69

Western Region Office

Tahliya Street
P.O Box 20798 Jeddah 21465

Tel : +966 12 6650888
Fax: +966 12 6633413

Eastern Region Office

King Abdulaziz Street
P.O Box 8492 Dammam 31482

Tel : +966 13 8336509
Fax: +966 13 8329065

ContactUs@noortek.com



www.noortek.com