



SURFACE MOUNTED

SURFLUX T8

SURFACE MOUNTED

SURFLUX T8



SPECIFICATIONS :

Mounting	: Ceiling mounted
Lamp type	: T8
Lamp holder	: G13
Control gear type	: Electronic
Voltage rating/ freq.	: 220-240V / 50-60 Hz
Power factor	: >0.95
Degree of protection	: IP 20
Internal wiring	: 0.5 mm sq. solid copper wire, PVC 105 deg C
Cable entry	: 16mm dia. hole on bottom of the housing
Cable connection	: Terminal block, 3-pole, screw type with grounding
Conformity	: IEC 60598 / SASO 1318
Light controller	: SP-S/DP-S/SP-M/DP-M

DESCRIPTIONS : SURFLUX T8 is a ceiling mounted luminaire of 0.6 mm steel housing finished with 3-stages pretreatment electrostatic powder coating. The aluminum optic is used with purity higher than 99% and reflectance higher than 80% for LOR reaches up to 64%. DIAL certified photometry. Energy efficiency is obtained using an electronic ballast with PF higher than 0.95.

APPLICATIONS : Offices, meeting rooms and apartments.



SURFACE MOUNTED

SURFLUX T8

Glare Evaluation According to UGR

Room Size		Viewing direction at right angles to lamp axis					Viewing direction parallel to lamp axis				
X	Y										
ρ Ceiling		70	70	50	50	30	70	70	50	50	30
ρ Walls		50	30	50	30	30	50	30	50	30	30
ρ Floor		20	20	20	20	20	20	20	20	20	20
2H	2H	13.5	14.6	13.7	14.8	15.0	11.6	12.7	11.9	12.9	13.1
	3H	14.2	15.2	14.6	15.5	15.7	11.5	12.4	11.8	12.7	12.9
	4H	14.4	15.4	14.8	15.6	15.9	11.4	12.3	11.7	12.6	12.8
	6H	14.6	15.4	14.9	15.7	16.0	11.3	12.1	11.7	12.4	12.7
	8H	14.6	15.4	15.0	15.7	16.1	11.3	12.1	11.6	12.4	12.7
	12H	14.7	15.4	15.0	15.7	16.1	11.2	12.0	11.6	12.3	12.6
4H	2H	13.6	14.5	13.9	14.8	15.0	11.9	12.8	12.3	13.1	13.4
	3H	14.5	15.3	14.9	15.6	15.9	11.9	12.6	12.2	12.9	13.3
	4H	14.8	15.5	15.2	15.8	16.2	11.8	12.5	12.2	12.8	13.2
	6H	15.0	15.6	15.4	16.0	16.4	11.8	12.3	12.2	12.7	13.1
	8H	15.1	15.6	15.5	16.0	16.4	11.7	12.2	12.2	12.6	13.0
	12H	15.1	15.6	15.6	16.0	16.4	11.7	12.2	12.1	12.6	13.0
8H	4H	14.7	15.3	15.2	15.7	16.1	11.9	12.4	12.3	12.8	13.2
	6H	15.0	15.4	15.5	15.9	16.3	11.9	12.3	12.3	12.7	13.2
	8H	15.1	15.5	15.6	16.0	16.4	11.9	12.2	12.3	12.7	13.1
	12H	15.2	15.5	15.7	16.0	16.5	11.8	12.1	12.3	12.6	13.1
12H	4H	14.7	15.2	15.2	15.6	16.0	11.9	12.4	12.4	12.8	13.2
	6H	15.0	15.4	15.5	15.8	16.3	11.9	12.3	12.4	12.7	13.2
	8H	15.1	15.4	15.6	15.9	16.4	11.9	12.2	12.4	12.7	13.2

Variation of the observer position for the luminaire distances S			
S =1.0H		+0.4 / -0.5	+0.2 / -0.6
S =1.5H		+0.6 / -1.2	+1.5 / -4.8
S =2.0H		+1.4 / -2.2	+3.0 / -9.1
Standard table		BK02	BK01
Correction Summand		-7.9	-10.1

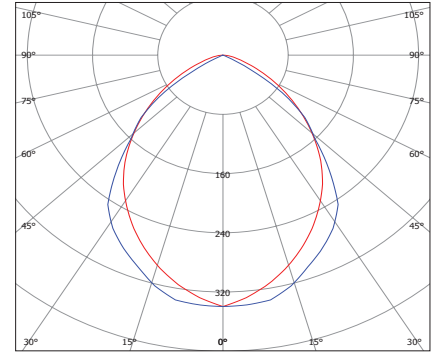

SUR-T8-3X18WE/SP-S
For the rest refer to page - 429
LOR: 6.4%

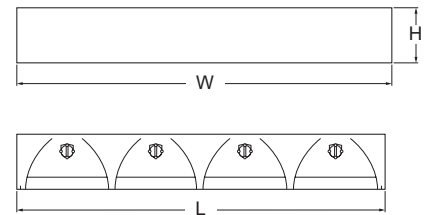

Corrected Glare Indices referring to 3150lm Total Luminous Flux
The UGR values have been calculated according to CIE Publ. 117 Spacing-to-Height-Ratio = 1.00.

CODE	L	W	H
SUR-T8-3/4X18WE/SP-S	613	613	90
SUR-T8-3/4X18WE/DP-S	613	613	90
SUR-T8-3/4X18WE/SP-M	613	613	90
SUR-T8-3/4X18WE/DP-M	613	613	90

- OPTIONS:**
- Gear (DIM) [DALI]
 - Emergency Kit (EM1.5) [EM3]



Ordering Example



Mounting System

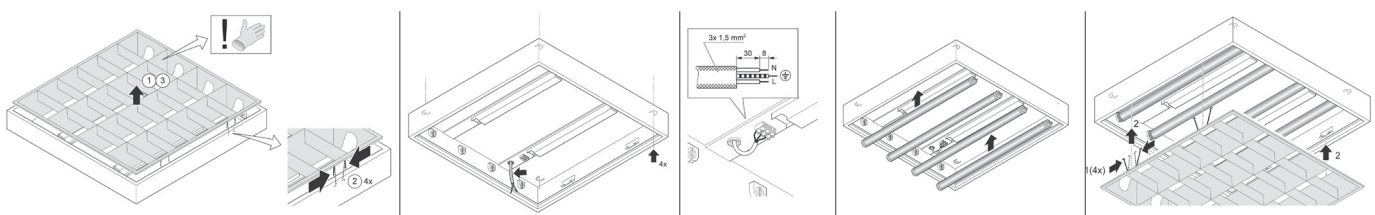

SURFACE MOUNTED

SURFLUX T8



SPECIFICATIONS :

Mounting	: Ceiling mounted
Lamp type	: T8
Lamp holder	: G13
Control gear type	: Electronic
Voltage rating/ freq.	: 220-240V / 50-60 Hz
Power factor	: >0.95
Degree of protection	: IP 20
Internal wiring	: 0.5 mm sq. solid copper wire, PVC 105 deg C
Cable entry	: 16mm dia. hole on bottom of the housing
Cable connection	: Terminal block, 3-pole, screw type with grounding
Conformity	: IEC 60598 / SASO 1318
Light controller	: SP-S/DP-S/SP-M/DP-M

DESCRIPTIONS : SURFLUX T8 is a ceiling mounted luminaire of 0.6 mm steel housing finished with 3-stages pretreatment electrostatic powder coating. The aluminum optic is used with purity higher than 99% and reflectance higher than 80% for LOR reaches up to 69%. DIAL certified photometry. Energy efficiency is obtained using an electronic ballast with PF higher than 0.95.

APPLICATIONS : Offices, meeting rooms and apartments.



SURFACE MOUNTED

SURFLUX T8

Glare Evaluation According to UGR

Room Size		Viewing direction at right angles to lamp axis					Viewing direction parallel to lamp axis				
X	Y										
ρ Ceiling		70	70	50	50	30	70	70	50	50	30
ρ Walls		50	30	50	30	30	50	30	50	30	30
ρ Floor		20	20	20	20	20	20	20	20	20	20
2H	2H	15.0	16.1	15.2	16.3	16.5	10.8	11.9	11.1	12.1	12.4
	3H	15.9	16.9	16.2	17.2	17.4	10.7	11.7	11.0	11.9	12.2
	4H	16.2	17.1	16.5	17.3	17.6	10.6	11.5	10.9	11.8	12.1
	6H	16.3	17.1	16.6	17.4	17.7	10.5	11.4	10.9	11.7	12.0
	8H	16.3	17.1	16.7	17.4	17.8	10.5	11.3	10.8	11.6	11.9
	12H	16.3	17.1	16.7	17.4	17.7	10.5	11.2	10.8	11.5	11.9
4H	2H	15.0	15.9	15.3	16.2	16.4	11.3	12.2	11.6	12.5	12.8
	3H	16.1	16.8	16.4	17.1	17.5	11.2	12.0	11.6	12.3	12.6
	4H	16.4	17.1	16.8	17.4	17.7	11.2	11.8	11.5	12.2	12.5
	6H	16.6	17.2	17.0	17.6	17.9	11.1	11.7	11.5	12.0	12.4
	8H	16.7	17.2	17.1	17.6	18.0	11.0	11.6	11.5	12.0	12.4
	12H	16.7	17.2	17.1	17.6	18.0	11.0	11.5	11.5	11.9	12.3
8H	4H	16.3	16.8	16.7	17.2	17.6	11.3	11.8	11.7	12.2	12.6
	6H	16.6	17.0	17.0	17.4	17.9	11.3	11.7	11.7	12.1	12.6
	8H	16.7	17.1	17.2	17.5	18.0	11.2	11.6	11.7	12.0	12.5
	12H	16.7	17.1	17.2	17.5	18.0	11.2	11.5	11.7	12.0	12.5
12H	4H	16.3	16.7	16.7	17.2	17.6	11.3	11.8	11.8	12.2	12.6
	6H	16.5	16.9	17.0	17.4	17.8	11.3	11.7	11.8	12.1	12.6
	8H	16.6	17.0	17.1	17.4	17.9	11.3	11.6	11.8	12.1	12.6

Variation of the observer position for the luminaire distances S			
S = 1.0H		+0.2 / -0.3	+0.6 / -1.1
S = 1.5H		+0.7 / -0.9	+1.9 / -6.0
S = 2.0H		+1.8 / -2.1	+3.3 / -10.1
Standard table		BK03	BK01
Correction Summand		-9.6	-13.7

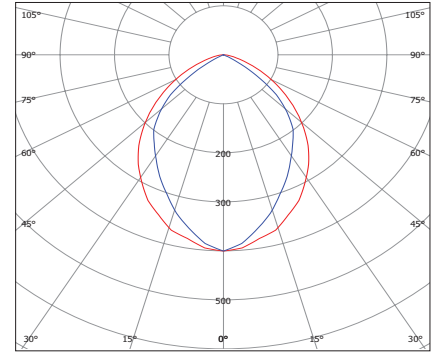

SUR-T8-3X36WE/SP-S
For the rest refer to page - 429
LOR: 69%

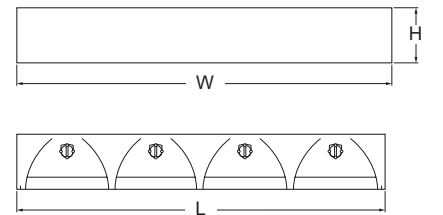

Corrected Glare Indices referring to 10350lm Total Luminous Flux
The UGR values have been calculated according to CIE Publ. 117 Spacing-to-Height-Ratio = 1.00.

CODE	L	W	H
SUR-T8-3/4X36WE/SP-S	1222	613	90
SUR-T8-3/4X36WE/DP-S	1222	613	90
SUR-T8-3/4X36WE/SP-M	1222	613	90
SUR-T8-3/4X36WE/DP-M	1222	613	90

- OPTIONS:**
- Gear (DIM) [DALI]
 - Emergency Kit (EM1.5) [EM3]



Ordering Example



Mounting System

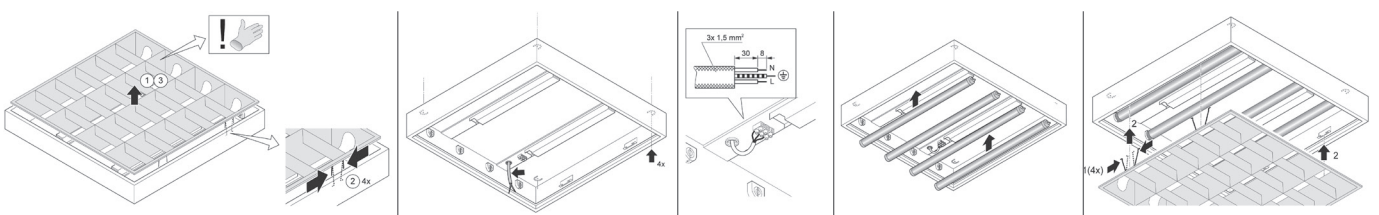

SURFACE MOUNTED

SURFLUX T8

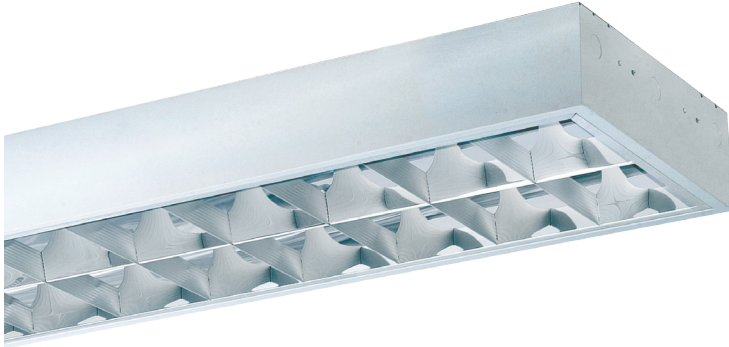

SPECIFICATIONS :

Mounting	: Ceiling mounted
Lamp type	: T8
Lamp holder	: G13
Control gear type	: Electronic
Voltage rating/ freq.	: 220-240V / 50-60 Hz
Power factor	: >0.95
Degree of protection	: IP 20
Internal wiring	: 0.5 mm sq. solid copper wire, PVC 105 deg C
Cable entry	: 16mm dia. hole on bottom of the housing
Cable connection	: Terminal block, 3-pole, screw type with grounding
Conformity	: IEC 60598 / SASO 1318
Light controller	: SP-S/DP-S/SP-M/DP-M

DESCRIPTIONS : SURFLUX T8 is a ceiling mounted luminaire of 0.6 mm steel housing finished with 3-stages pretreatment electrostatic powder coating. The aluminum optic is used with purity higher than 99% and reflectance higher than 80% for LOR reaches up to 60%. DIAL certified photometry. Energy efficiency is obtained using an electronic ballast with PF higher than 0.95.

APPLICATIONS : Offices, meeting rooms and apartments.



SURFACE MOUNTED

SURFLUX T8

Glare Evaluation According to UGR

Room Size		Viewing direction at right angles to lamp axis					Viewing direction parallel to lamp axis				
X	Y										
ρ Ceiling		70	70	50	50	30	70	70	50	50	30
ρ Walls		50	30	50	30	30	50	30	50	30	30
ρ Floor		20	20	20	20	20	20	20	20	20	20
2H	2H	0.1	1.1	0.3	1.3	1.5	17.5	18.5	17.8	18.7	19.0
	3H	0.5	1.5	0.8	1.7	1.9	18.5	19.4	18.8	19.6	19.9
	4H	0.6	1.4	0.9	1.7	2.0	18.7	19.6	19.0	19.8	20.1
	6H	0.6	1.4	0.9	1.6	1.9	18.9	19.7	19.2	19.9	20.2
	8H	0.5	1.3	0.9	1.6	1.9	18.9	19.7	19.3	20.0	20.3
	12H	0.5	1.2	0.9	1.6	1.9	19.0	19.7	19.3	20.0	20.3
4H	2H	3.3	4.2	3.7	4.5	4.7	17.3	18.2	17.7	18.5	18.7
	3H	4.6	5.4	5.0	5.7	6.0	18.4	19.1	18.7	19.4	19.7
	4H	5.0	5.6	5.4	5.9	6.3	18.7	19.3	19.1	19.7	20.0
	6H	5.1	5.6	5.5	6.0	6.4	19.0	19.5	19.4	19.9	20.3
	8H	5.1	5.6	5.5	6.0	6.4	19.1	19.6	19.5	20.0	20.4
	12H	5.1	5.5	5.5	5.9	6.4	19.2	19.6	19.6	20.0	20.4
8H	4H	7.0	7.5	7.4	7.9	8.3	18.6	19.1	19.1	19.5	19.9
	6H	7.5	7.9	7.9	8.3	8.7	19.0	19.4	19.4	19.8	20.2
	8H	7.6	7.9	8.1	8.4	8.8	19.1	19.5	19.6	19.9	20.4
	12H	7.6	7.9	8.1	8.4	8.9	19.3	19.5	19.7	20.0	20.5
12H	4H	7.4	7.9	7.9	8.3	8.7	18.6	19.0	19.0	19.4	19.9
	6H	8.0	8.4	8.5	8.8	9.3	18.9	19.3	19.4	19.7	20.2
	8H	8.2	8.5	8.7	9.0	9.5	19.1	19.4	19.6	19.9	20.4

Variation of the observer position for the luminaire distances S		
S = 1.0H	+1.3 / -3.6	+0.3 / -0.4
S = 1.5H	+2.6 / -5.0	+0.7 / -1.1
S = 2.0H	+3.9 / -5.7	+1.8 / -2.3
Standard table	BK02	BK03
Correction Summand	-13.4	-6.5

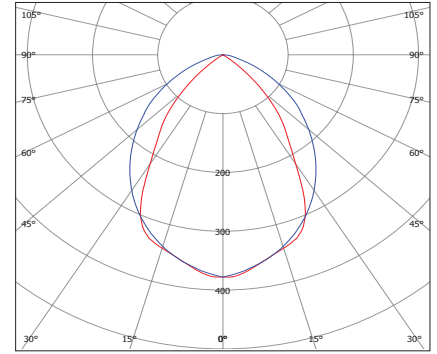

SUR-T8-2X36WE/SP-S
For the rest refer to page - 429 **LOI: 60%**

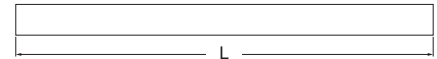
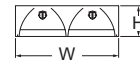

Corrected Glare Indices referring to 6700lm Total Luminous Flux
The UGR values have been calculated according to CIE Publ. 117 Spacing-to-Height-Ratio = 1.00.

CODE	L	W	H
SUR-T8-2X36WE/SP-S	1222	302	90
SUR-T8-2X36WE/DP-S	1222	302	90
SUR-T8-2X36WE/SP-M	1222	302	90
SUR-T8-2X36WE/DP-M	1222	302	90

- OPTIONS:**
 - Gear (DIM) [DALI]
 - Emergency Kit (EM1.5) [EM3]



Ordering Example



Mounting System

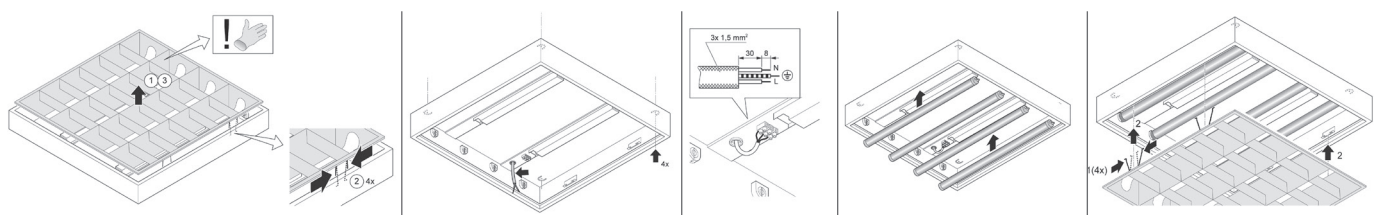

Head office

Malaz - Salahidin Road
P.O Box 1246 Riyadh 11431

Tel : +966 11 477 77 00
Fax: +966 11 478 94 69

Western Region Office

Tahliya Street
P.O Box 20798 Jeddah 21465

Tel : +966 12 6650888
Fax: +966 12 6633413

Eastern Region Office

King Abdulaziz Street
P.O Box 8492 Dammam 31482

Tel : +966 13 8336509
Fax: +966 13 8329065

ContactUs@noortek.com



www.noortek.com