



DOWNLIGHTS

DOLUX 9" SQUARE IP 40/44

DOWNLIGHTS

DOLUX 9" SQUARE IP 40/44



SPECIFICATIONS :

Mounting	: Ceiling recessed
Lamp type	: CFL
Lamp holder	: G24q
Control gear type	: Electronic
Voltage Rating/ Freq.	: 220-240V / 50-60 Hz
Power factor	: >0.95
Degree of protection	: IP 40/44
Internal Wiring	: 0.5 mm sq. solid copper wire PVC 105 deg C
Cable entry	: 16mm dia. holes at the end of the gear box
Cable connection	: Terminal block, 3-pole, screw type with grounding ²
Conformity	: IEC 60598 / SASO 1318
Light controller	: CA-SqFG

DESCRIPTIONS : DOLUX 9" square is a recessed luminaire of 0.6 mm steel housing finished with 3-stages pretreatment electrostatic powder coating. The trim is made of die casted aluminum. The aluminum optic is used with purity higher than 99% and reflectance higher than 80% for LOR reaches up to 61%. DIAL certified photometry. Energy efficiency is obtained using an electronic ballast with PF higher than 0.95.

APPLICATIONS : Offices and multi-purposes applications.



DOWNLIGHTS

DOLUX 9" SQUARE IP 40/44
FLUSH DIFFUSER

Glare Evaluation According to UGR

Room Size		Viewing direction at right angles to lamp axis					Viewing direction parallel to lamp axis				
X	Y	16.2	17.4	16.5	17.7	17.9	20.6	21.9	20.9	22.1	22.4
2H	2H	16.2	17.4	16.5	17.7	17.9	20.6	21.9	20.9	22.1	22.4
	3H	16.8	17.9	17.1	18.2	18.5	21.7	22.8	22.0	23.1	23.3
	4H	16.9	18.0	17.3	18.3	18.5	21.9	23.0	22.3	23.3	23.5
	6H	16.9	17.9	17.3	18.2	18.5	22.0	23.0	22.4	23.3	23.6
	8H	16.9	17.9	17.3	18.2	18.5	22.0	22.9	22.4	23.3	23.6
4H	12H	16.9	17.8	17.3	18.1	18.5	22.0	22.9	22.4	23.2	23.5
	2H	16.7	17.8	17.0	18.1	18.3	20.6	21.7	21.0	22.0	22.3
	3H	17.6	18.5	17.9	18.8	19.1	21.9	22.7	22.2	23.1	23.4
	4H	17.8	18.6	18.2	18.9	19.3	22.2	23.0	22.6	23.3	23.7
	6H	17.8	18.5	18.3	18.9	19.3	22.3	23.0	22.8	23.4	23.8
8H	8H	17.9	18.5	18.3	18.9	19.3	22.4	23.0	22.8	23.4	23.8
	12H	17.8	18.4	18.3	18.8	19.2	22.3	22.9	22.8	23.3	23.7
	4H	18.0	18.6	18.4	19.0	19.4	22.2	22.8	22.6	23.2	23.6
	6H	18.1	18.6	18.5	19.0	19.5	22.3	22.8	22.8	23.3	23.7
	8H	18.1	18.6	18.6	19.0	19.5	22.4	22.8	22.8	23.3	23.7
12H	12H	18.1	18.5	18.6	19.0	19.4	22.4	22.7	22.9	23.2	23.7
	4H	18.0	18.5	18.4	18.9	19.4	22.1	22.7	22.6	23.1	23.5
	6H	18.1	18.5	18.6	19.0	19.5	22.3	22.8	22.8	23.2	23.7
	8H	18.1	18.5	18.6	19.0	19.5	22.3	22.7	22.8	23.2	23.7

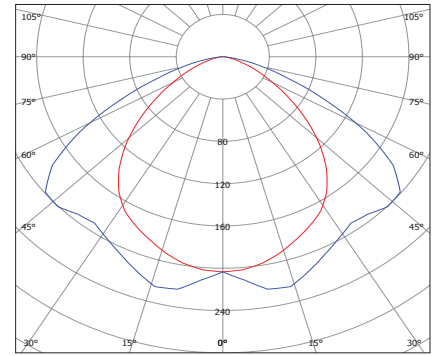

DLS[9"]-CFL-1X26WE/CA-SqFG [WH] LOR:61%
For the rest refer to page - 433

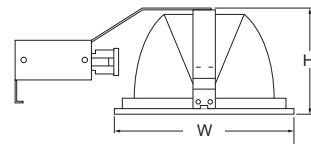

Corrected Glare Indices referring to 1800lm Total Luminous Flux
The UGR values have been calculated according to CIE Publ. 117 Spacing-to-Height-Ratio = 1.00.

CODE	W	H
DLS[9"]-CFL-1/2X26WE/CA-SqFG [WH] [IP40]	240	125
DLS[9"]-CFL-1/2X26WE/CA-SqFG [WH] [IP44]	240	125

CODE	W	H
DLS[9"]-CFL-1/2X32WE/CA-SqFG [WH] [IP40]	240	125
DLS[9"]-CFL-1/2X32WE/CA-SqFG [WH] [IP44]	240	125

OPTIONS:

- Lamp holders [E27]
- Gear [DIM] [DALI]
- Emergency Kit [EM1.5] [EM3]
- Reflector [ASSY]
- Trim Color [WH] [GR] [AU]



Ordering Example

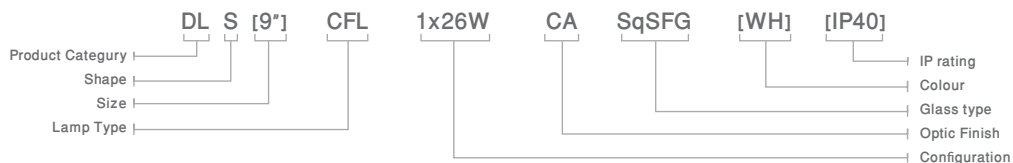

Mounting System

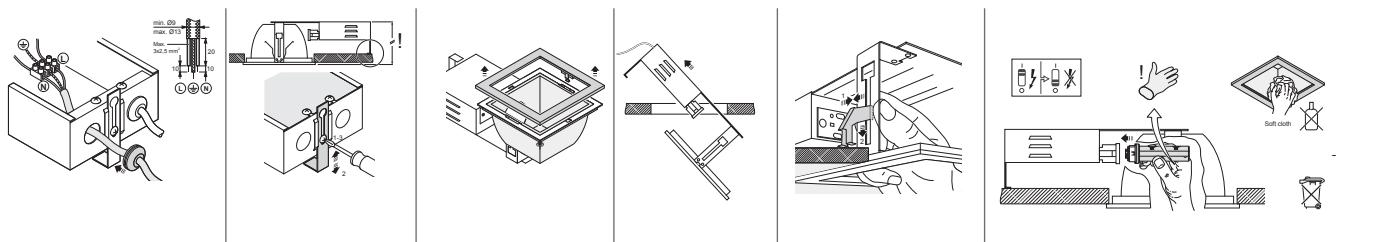

Head office

Malaz - Salahidin Road
P.O Box 1246 Riyadh 11431

Tel : +966 11 477 77 00
Fax: +966 11 478 94 69

Western Region Office

Tahliya Street
P.O Box 20798 Jeddah 21465

Tel : +966 12 6650888
Fax: +966 12 6633413

Eastern Region Office

King Abdulaziz Street
P.O Box 8492 Dammam 31482

Tel : +966 13 8336509
Fax: +966 13 8329065

ContactUs@noortek.com



www.noortek.com